

RADHA KRISHNA CONSTRUCTION

Ref.:

Date:

TO WHOME IT MAY CONCERN

Sir,

Location plan for the land on which development of our proposed project “RADHA KRISHNA ENCLAVE” is going on is laying and situated at Premises No-260, A.C. Sarkar Road, P.O- Dakshineswar, & P.S. Belgharia, Kolkata-700076 under the limits of the Kamarhati Municipality. District-North 24 Parganas, J.L No-4, R.S No-1, Touzi Nos- 63,163,166,168 & 222 comprised in Dag No-1223, under Khatian No-1173, Ward No-15, Holding No-708, is shown below

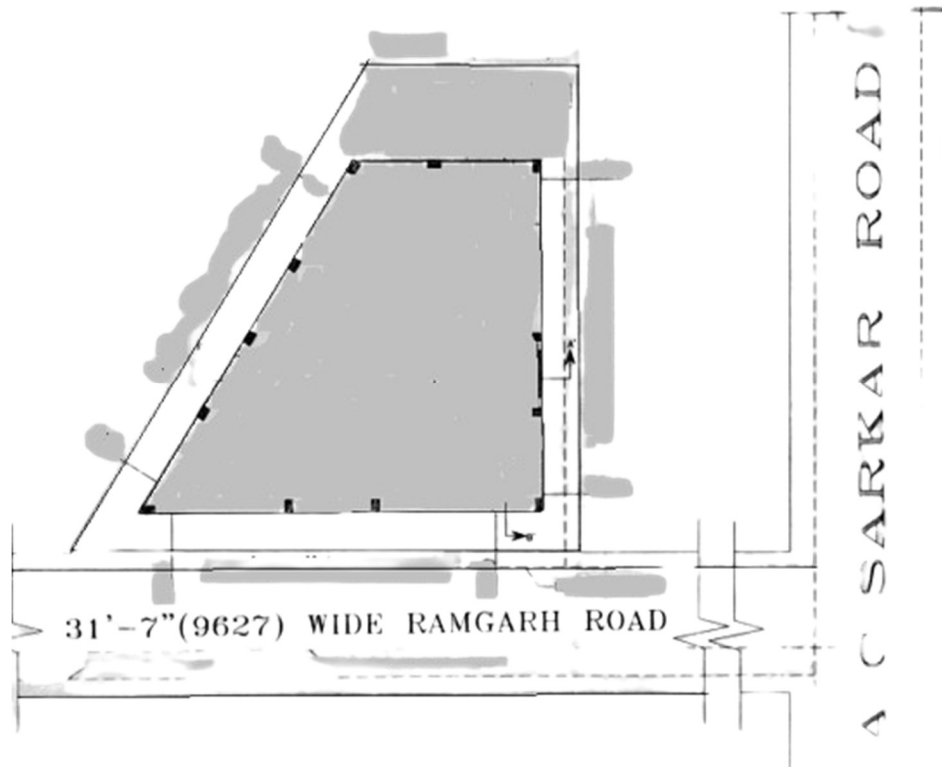

Latitude: 22°66'07.00"N

Longitude: 88°36'56.40"E

For, RADHA KRISHNA CONSTRUCTION,

M/s. RADHA KRISHNA CONSTRUCTION

ARUN K. Ghosh
Partner